



Traffic Count Map

Prepared by Craig Hunter

6600 Commercial Pkwy
 6600 W Commercial Park Ave, Rathdrum, ID 83858-6427
 Ring: 1, 4, 8 Miles

Latitude: 47.816185
 Longitude: -116.875023

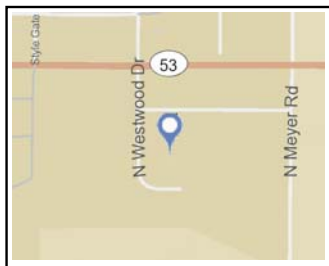
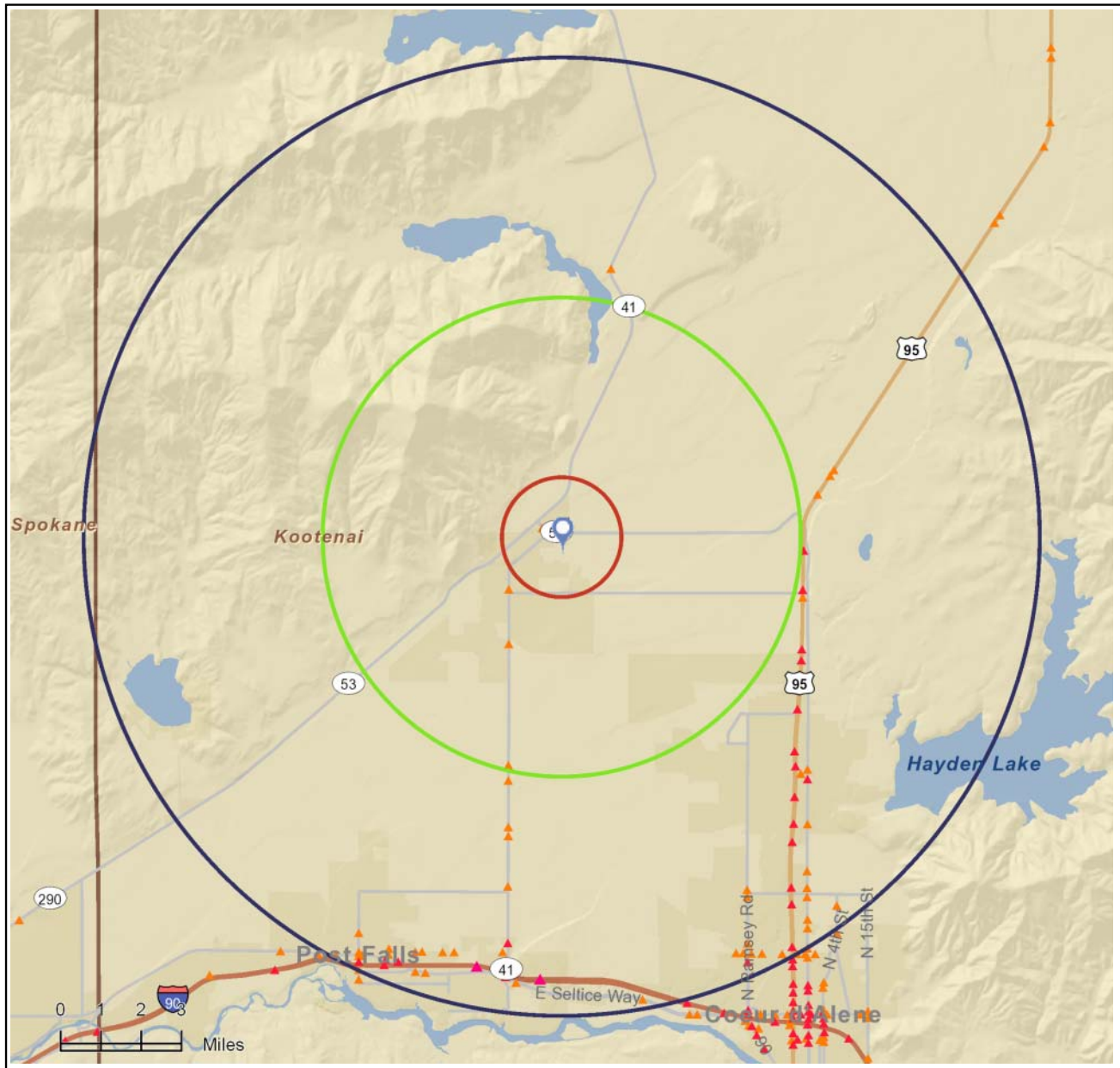

- Average Daily Traffic Volume**
- ▲ Up to 6,000 vehicles per day
 - ▲ 6,001 - 15,000
 - ▲ 15,001 - 30,000
 - ▲ 30,001 - 50,000
 - ▲ 50,001 - 100,000
 - ▲ More than 100,000 per day



Source: © 2010 MPSI (Market Planning Solutions Inc.) Systems Inc. d.b.a. DataMetrix®



Traffic Count Profile

Prepared by Craig Hunter

6600 Commercial Pkwy
6600 W Commercial Park Ave, Rathdrum, ID 83858-6427
Ring: 8 miles radius

Latitude: 47.816185
Longitude: -116.875023

| Distance: | Street: | Closest Cross-street: | Year of Count: | Count: |
|-----------|--------------------------|---|----------------|--------|
| 0.21 | State Highway 53 | State Highway 41 (0.05 miles SW) | 2003 | 7,100 |
| 0.36 | State Highway 53 | State Highway 41 (0.13 miles SE) | 2003 | 9,600 |
| 0.44 | State Highway 53 | State Highway 41 (0.05 miles NW) | 1999 | 7,100 |
| 0.47 | State Highway 41 | Legacy Dr (0.07 miles NE) | 2003 | 8,000 |
| 0.53 | State Highway 53 | W Sylte Ranch Rd (0.0 miles) | 2003 | 7,000 |
| 1.23 | State Highway 41 | Montana St (0.06 miles N) | 1999 | 9,200 |
| 1.98 | State Highway 41 | W Lancaster Rd (0.15 miles S) | 2003 | 9,900 |
| 2.06 | State Highway 53 | N Atlas Rd (0.06 miles E) | 1965 | 1,530 |
| 2.18 | State Highway 53 | N Atlas Rd (0.05 miles W) | 1965 | 905 |
| 2.22 | State Highway 41 | W Lancaster Rd (0.12 miles N) | 1967 | 1,307 |
| 3.10 | N Ramsey Rd | State Highway 53 (0.09 miles N) | 1992 | 194 |
| 3.10 | N Ramsey Rd | State Highway 53 (0.09 miles S) | 1992 | 938 |
| 3.21 | State Highway 53 | N Ramsey Rd (0.11 miles W) | 2003 | 4,800 |
| 3.90 | N Huetter Rd | W Hayden Ave (0.19 miles S) | 1992 | 72 |
| 3.90 | State Highway 41 | W Hayden Ave (0.13 miles S) | 1995 | 9,141 |
| 3.93 | W Hayden Ave | N Meyer Rd (0.08 miles E) | 1966 | 601 |
| 3.93 | W Hayden Ave | N Meyer Rd (0.09 miles W) | 1966 | 621 |
| 4.00 | W Hayden Ave | State Highway 41 (0.13 miles W) | 1995 | 4,573 |
| 4.03 | United States Highway 95 | W Murphy Rd (0.21 miles S) | 2003 | 17,000 |
| 4.04 | W Hayden Ave | N Memory Ln (0.12 miles W) | 1992 | 3,560 |
| 4.05 | W Hayden Ave | State Highway 41 (0.12 miles E) | 1995 | 320 |
| 4.05 | W Boekel Rd | United States Highway 95 (0.07 miles E) | 1989 | 163 |
| 4.10 | W Hayden Ave | N Huetter Rd (0.1 miles W) | 1992 | 3,526 |
| 4.11 | United States Highway 95 | W Boekel Rd (0.05 miles S) | 1999 | 19,000 |
| 4.14 | United States Highway 95 | W Boekel Rd (0.08 miles N) | 1990 | 10,152 |
| 4.15 | State Highway 41 | W Hayden Ave (0.13 miles N) | 1995 | 10,216 |
| 4.18 | W Boekel Rd | N Government Way (0.02 miles E) | 1989 | 89 |
| 4.24 | N Huetter Rd | W Orchard Ave (0.09 miles S) | 1992 | 170 |
| 4.30 | W Lancaster Rd | N Reed Rd (0.13 miles W) | 1997 | 133 |
| 4.41 | United States Highway 95 | W Lancaster Rd (0.08 miles S) | 1997 | 18,841 |

Data Note: The Traffic Profile displays up to 25 of the closest available traffic counts within the largest radius around your site. The years of the counts in the database range from 2010 to 1963. Just over 66% of the counts were taken between 2001 and 2010 and 86% of the counts were taken in 1997 or later. Traffic counts are identified by the street on which they were recorded, along with the distance and direction to the closest cross-street. Distances displayed as 0.00 miles (due to rounding), are closest to the site. A traffic count is defined as the two-way Average Daily Traffic (ADT) that passes that location.

Source: © 2010 MPSI (Market Planning Solutions Inc.) Systems Inc. d.b.a. DataMetrix®



Traffic Count Map - Close Up

Prepared by Craig Hunter

6600 Commercial Pkwy
 6600 W Commercial Park Ave, Rathdrum, ID 83858-6427
 Ring: 1, 4, 8 Miles

Latitude: 47.816185
 Longitude: -116.875023



- Average Daily Traffic Volume**
- ▲ Up to 6,000 vehicles per day
 - ▲ 6,001 - 15,000
 - ▲ 15,001 - 30,000
 - ▲ 30,001 - 50,000
 - ▲ 50,001 - 100,000
 - ▲ More than 100,000 per day



Source: © 2010 MPSI (Market Planning Solutions Inc.) Systems Inc. d.b.a. DataMetrix®